

PLEASE NOTE:

- 1) FOR SAFE OPERATION AND CONTINUED HIGH PERFORMANCE FROM THIS EQUIPMENT, INSPECTION AND MAINTENANCE MUST BE PERFORMED BEFORE EACH USE
- 2) USE OF THIS EQUIPMENT OTHER THAN INTENDED, MAY BE HAZARDOUS.
- 3) ALTERATION OR MODIFICATION OF EQUIPMENT MAY BE HAZARDOUS. FOR REPAIR OR REPLACEMENT, PLEASE CALL YOUR DEALER

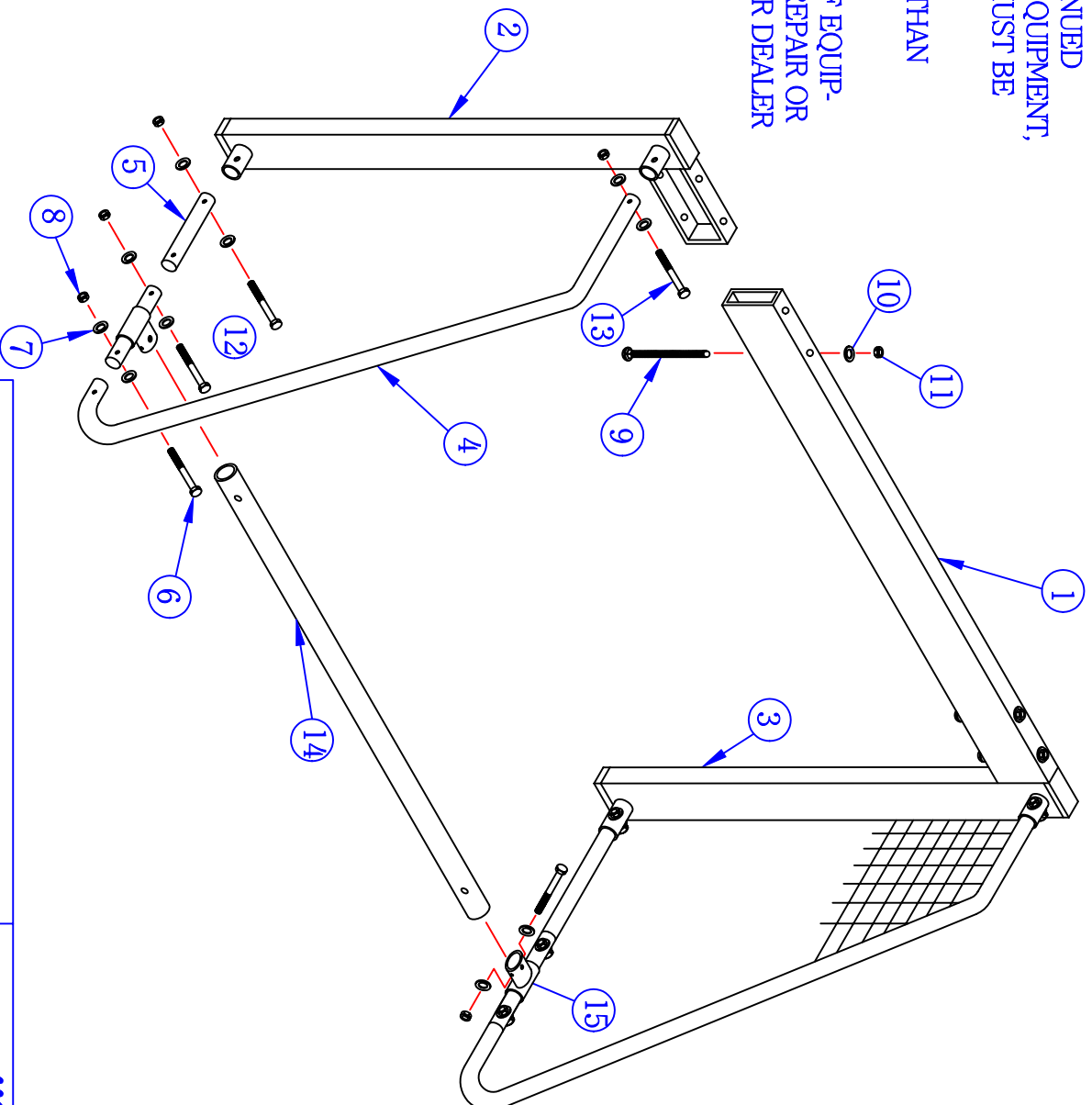

**CAUTION**

DO NOT HANG OR SWING  
FROM CROSSBAR

**JAYPRO SPORTS**

976 HARTFORD TURNPIKE  
WATERFORD, CT 06385 USA

(800)243-0533

(800)988-3363 FAX

WWW.JAYPRO.COM

MODEL NO.:  
**SGP-100**

PRODUCT NAME:  
**SOCGER GOAL**

DRAWN BY: JAC

EFFECTIVE DATE:  
5-28-03

**ASSEMBLY TYPICAL FOR  
UPRIGHTS AND CROSSBARS**

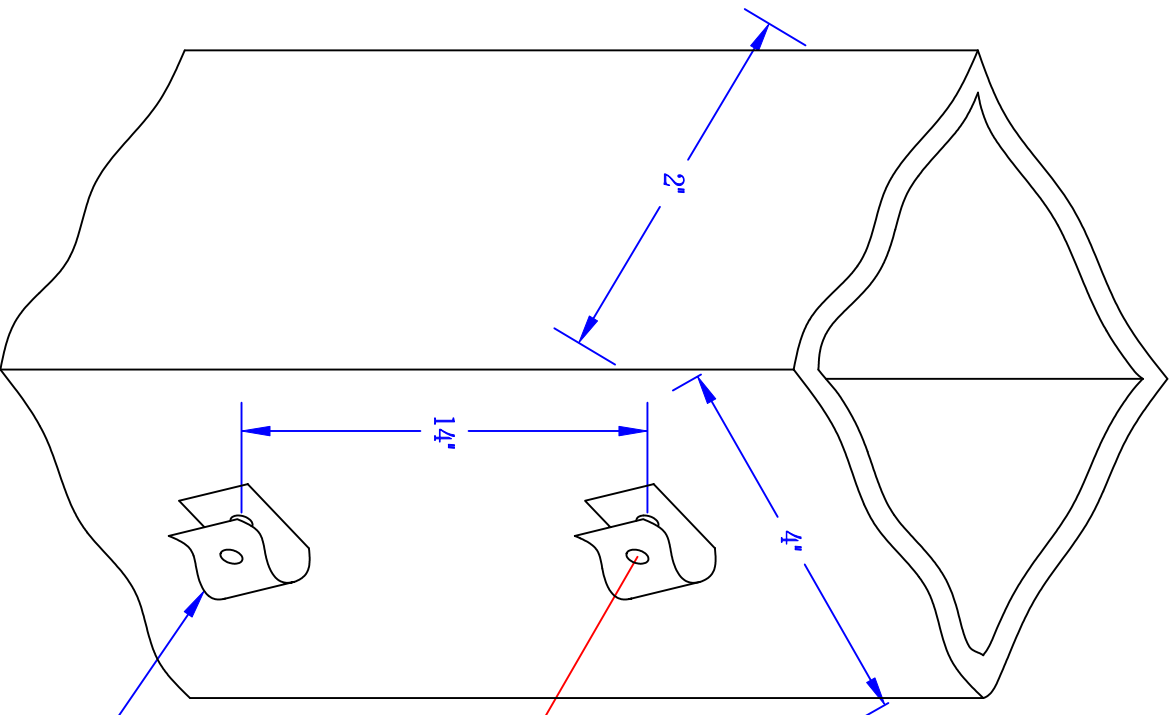

**#2 PHILLIPS BIT REQUIRED**



**#8 PAN-SHAPED  
PHILLIPS-HEAD  
SELF-DRILLING  
SCREW.(HS5035)**

**NET CLIP (HM5076)**

**ASSEMBLY INSTRUCTIONS**

1) FOR BEST RESULTS, USE AN ELECTRIC POWERED HAND-HELD SCREWDRIVER WITH A #2 PHILLIPS BIT. ROUGHLY LAY OUT THE PLACEMENT OF EACH NET CLIP 14" ON CENTER OF THE REAR SIDE OF EACH UPRIGHT AND CROSSBAR.

2) PLACE A SELF-DRILLING SCREW ONTO THE #2 PHILLIPS BIT AND THROUGH THE MOUNTING HOLE OF THE NET CLIP. POSITION THE TIP OF THE SCREW IN THE PROPER LOCATION AND DRIVE IT FULLY INTO THE MATERIAL. REPEAT THE PROCESS FOR ALL REMAINING NET

EACH UPRIGHT- SEVEN CLIPS

EACH CROSSBAR-TWENTY CLIPS

**JAYPRO SPORTS**

**976 HARTFORD TURNPIKE  
WATERFORD, CT 06385 USA**

**(800)243-0533  
(800)988-3363 FAX  
WWW.JAYPRO.COM**

**MODEL NO.:  
SGP-100**

**PRODUCT NAME:**

**NET CLIP ASSEMBLY**

**DRAWN BY: JAC**

**EFFECTIVE DATE:  
5-28-03**

**JAYPRO SPORTS**  
**SGP-100**  
**OFFICIAL ECONOMY SOCCER GOAL**  
**LIST OF MATERIALS**

<u>PIECE #</u>	<u>PART #</u>	<u>DESCRIPTION</u>	<u>QTY.</u>
1	SGP100XBS	CROSSBAR	2
2	SGP100UPR	UPRIGHT-RIGHT SIDE	2
3	SGP100UPL	UPRIGHT-LEFT SIDE	2
4	SGP760BS	BACKSTAY	4
5	SGP760C1	BACKSTAY CONNECTOR	4
6	HS1472	5/16"-18 x 2 1/2" HEX HD BOLT	8
7	HW2049	5/16" FLAT WASHER	32
8	HN261	5/16"-18 LOCKNUT	16
9	HB5010	3/8"-16 x 4 1/2" CARRIAGE BOLT	8
10	HW2050	3/8" FLAT WASHER	8
11	HN265	3/8"-16 LOCKNUT	8
12	SGP760RX3	BACKSTAY INSERT	4
13	HS283	5/16"-18 x 3" HEX HD BOLT	8
14	SGP760RX2	REAR CROSSBAR	2
15	SF177	2" TEE FITTING	4

**ASSEMBLY INSTRUCTIONS**

READ ALL INSTRUCTIONS CAREFULLY BEFORE BEGINNING THE ASSEMBLY.

Tools Required: 9/16" Box Wrench or Adjustable Wrench  
1/2" Box Wrench or Adjustable Wrench

- 1) Arrange the Backstay (4), Backstay Connector (5), and Backstay Sleeve (12) as shown and loosely fasten together using Hex Hd Bolts 5/16"-18 x 2 1/2" (6), Flat Washers 5/16" (7), and Locknuts 5/16"-18 (8). Slide 2" Tee Fitting (7) over Backstay Insert, then position the Rear Crossbar (14) between the assembled backstay frames and loosely fasten it into place using the 2" Tee Fitting and hardware as shown. The rear backstay frame will now stand on its own.
- 2) Lay the Crossbar (1) onto the ground and position the Left-Side Upright (3) and a Right-Side Upright (2) at each end. Assemble the uprights to the Crossbar using the Carriage Bolts 3/8"-16 x 4 1/2" (8), Flat washers 3/8" (10) and Locknut 3/8"-16 (9) as shown. Note: When the Carriage Bolt is first assembled it will not seat fully into the hole in the Crossbar. However, when it is tightened, the head will draw into the material and form a square hole to lock firmly in place.
- 3) Stand the assembled goal facing up so it is positioned in front of the assembled rear backstay frame as shown in the illustration. Slip the open ends off the backstay frame into the hubs welded to each upright and fasten loosely using the hardware as indicated. Square the goal and tighten all hardware firmly.

## INSTALLATION AND USE CONSIDERATIONS

- 1) To protect the players and the playing area, the Carriage Bolts 3/8"-16 x 4 1/2" (9) must assemble up from the bottom side of the Crossbar (1) as shown in the illustration. When this bolt is first assembled and tightened, it will create a small square impression underneath the head. This square hole will prevent the bolt from turning during assembly. Always insert the Carriage Bolt head into the square hole when performing this assembly operation.
- 2) Portability is an important characteristic of this soccer goal and the design and material that have been selected are intended to enhance this feature. Consequently, THIS GOAL MAY TIP OVER UNDER CERTAIN LOAD CONDITIONS, SUCH AS CLIMBING ONTO THE FRAME WORK OR HIGH WINDS. IT IS HIGHLY RECOMMENDED THAT THIS UNIT BE PROPERLY ANCHORED FOR IMPROVED STABILITY.
- 3) The size and weight of this portable soccer goal dictates that at least FOUR persons are required when carrying the unit. Position one person at each of the four corners, as shown in the illustration and lift carefully.
- 4) When fastening the net onto the goal, try tipping the goal onto its face. In addition, it is recommended that the soccer net be draped over the outside of the Backstays (4) and that the bottom edges of the net be tucked underneath the Backstays and Rear Crossbar (13). This will enclose the pocket behind the goal face and prevent the soccer ball from escaping the immediate playing area.

### IMPORTANT NOTICE

The United States Consumer Product Safety Commission has recently adopted and published "Guidelines for Moveable Soccer Goal Safety". These guidelines offer information on the installation, use and storage of full-size portable soccer goals and, through these guidelines, it is the commission's intent to help prevent serious injuries or death resulting from accidental soccer goal tipover.

Securely anchoring portable soccer goals, at all times, is one important and effective way to improve soccer goal safety. The proper selection of appropriate anchoring devices is dependent upon a number of factors and is unique to individual circumstances. Key elements to consider are:

- 1) Goal weight, inherent stability and type of construction.
- 2) Local field conditions and soil, moisture content.
- 3) Expected usage level and overall degree of field supervision.
- 4) The need to relocate or remove the goal on a regular or continuing basis.

As a charter member of the Coalition to Promote Soccer Goal Safety, Jaypro Sports endorses the efforts of the commission and others in this cause. Our trained sales staff is available to discuss the variety of goal anchors that we offer and to help you in making the best choice for your individual application.