

PLEASE NOTE:

- 1) FOR SAFE OPERATION AND CONTINUED HIGH PERFORMANCE FROM THIS EQUIPMENT, INSPECTION AND MAINTENANCE MUST BE PERFORMED BEFORE EACH USE
- 2) USE OF THIS EQUIPMENT OTHER THAN INTENDED, MAY BE HAZARDOUS.
- 3) ALTERATION OR MODIFICATION OF EQUIPMENT MAY BE HAZARDOUS. FOR REPAIR OR REPLACEMENT, PLEASE CALL YOUR DEALER

NOTE  
SLEEVE IS OPTIONAL  
FOR SEMI-PERMANENT  
INSTALLATION

CAUTION  
DO NOT HANG OR SWING  
FROM CROSSBAR

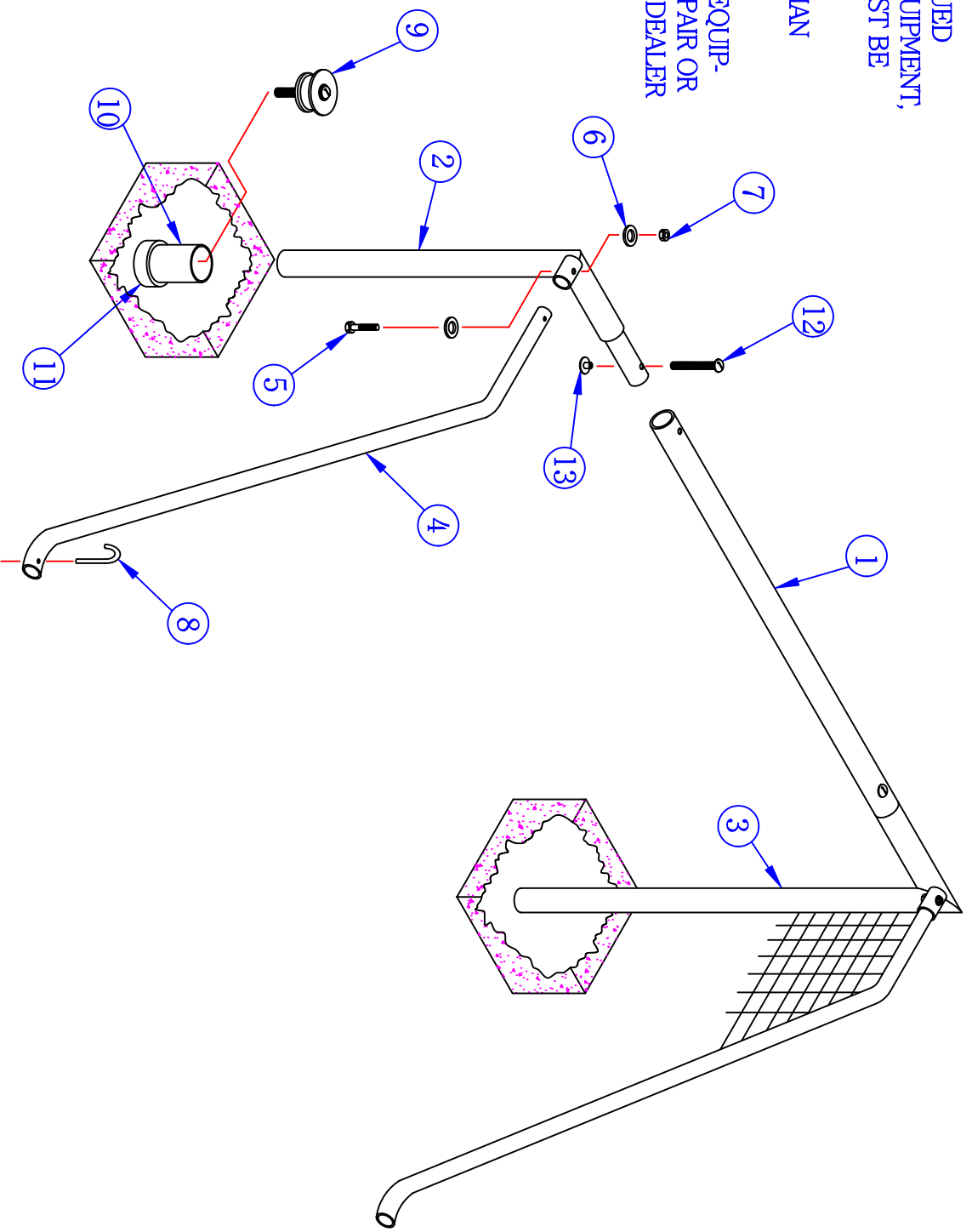

**JAYPRO SPORTS**

976 HARTFORD TURNPIKE  
WATERFORD, CT 06385 USA

(800)243-0533  
(800)988-3363 FAX  
WWW.JAYPRO.COM

MODEL NO.:  
**SGP-440**

PRODUCT NAME:  
**SOCCER GOAL**

DRAWN BY: JAC  
EFFECTIVE DATE:  
5-28-03

# JAYPRO SPORTS

OFFICIAL PERMANENT, SEMI-PERMANENT ROUND SOCCER GOAL, SGP-440

## LIST OF MATERIALS

<u>PIECE #</u>	<u>PART #</u>	<u>DESCRIPTION</u>	<u>QTY</u>	<u>REMARKS</u>
1	SGP400XBS	CROSSBAR	2	
2	SGP440UPR	UPRIGHT-RIGHT SIDE	2	
3	SGP440UPL	UPRIGHT-LEFT SIDE	2	
4	SGP-730BS	BACKSTAY	4	
5	HS5015	5/16"-18 x 2 1/4" HEX HD SCREW	4	
6	HW4074	5/16" RADIUS WASHER	8	
7	HN261	5/16"-18 LOCKNUT	4	
8	SR1467	GROUND STAKE	4	
9	EP0008	SLEEVE-TOP PLUG	4	SGP-445G ONLY
10	SGP445G1A	GROUND SLEEVE	4	SGP-445G ONLY
11	EC0014	SLEEVE-BOTTOM CAP	4	SGP-445G ONLY
12	HS4108	5/16"-18 x 4" RND HD MACHINE SCREW	4	
13	HN5041	5/16"-18 TEE NUT	4	

## ASSEMBLY INSTRUCTIONS

### **READ ALL DIRECTIONS CAREFULLY BEFORE BEGINNING THE ASSEMBLY.**

TOOLS REQUIRED: 1/2" BOX WRENCH OR ADJUSTABLE WRENCH (2)

- 1) Locate your position for the goal uprights (2 & 3) on the soccer field. The proper center to center upright spacing is 24'-4". Dig the footing holes to the dimensions as shown on the illustration. These are minimum suggested dimensions for average soil conditions.
- 2) To assure a proper alignment of the goal facing within the footing, it is necessary to assemble the uprights (2 & 3) to the Crossbar (1) before cementing the structure into place. Lay the Crossbar (1) onto the ground and position a Left-Side Upright (3) and a Right-Side Upright (2) at each end. Push the Uprights firmly into each end of the Crossbar (1) and make sure each insert is fully seated, then assemble with Machine Screw (12) and Tee Nut (13) as shown in the illustration.

### **Semi-Permanent Installation (SGP-445):**

- 3) Slip the Ground Sleeves (13) onto the bottom of each Upright and lower the assembled goal facing into the footings. Block beneath and around the Sleeves, plumb the structure and pour the footing. Check that the Ground Sleeves does not stick above the playing surface and that there is 8' from the playing surface to the underside of the Crossbar. Brace the structure to assure that it doesn't shift during the curing process.

### **Permanent Installation (SGP-445G REQUIRED):**

- Lower the assembled goal facing into the footings. Block beneath and around the Upright, plumb the structure and pour the footing. Check that the Ground Sleeves does not stick above the playing surface and that there is 8' from the playing surface to the underside of the Crossbar. Brace the structure to assure that it doesn't shift during the curing process.
- 4) Wait for the concrete to fully cure according to the manufacture's instructions. When this process is complete, assemble the backstays (4) as shown and stake the loose end securely to the ground.
  - 5) If the unit is removed from the Ground Sleeves for maintenance or storage, always cover the open end of the sleeve using the top cap (12) provided.