

PLEASE NOTE:

- 1) FOR SAFE OPERATION AND CONTINUED HIGH PERFORMANCE FROM THIS EQUIPMENT, INSPECTION AND MAINTENANCE MUST BE PERFORMED BEFORE EACH USE
- 2) USE OF THIS EQUIPMENT OTHER THAN INTENDED, MAY BE HAZARDOUS.
- 3) ALTERATION OR MODIFICATION OF EQUIPMENT MAY BE HAZARDOUS. FOR REPAIR OR REPLACEMENT, PLEASE CALL YOUR DEALER

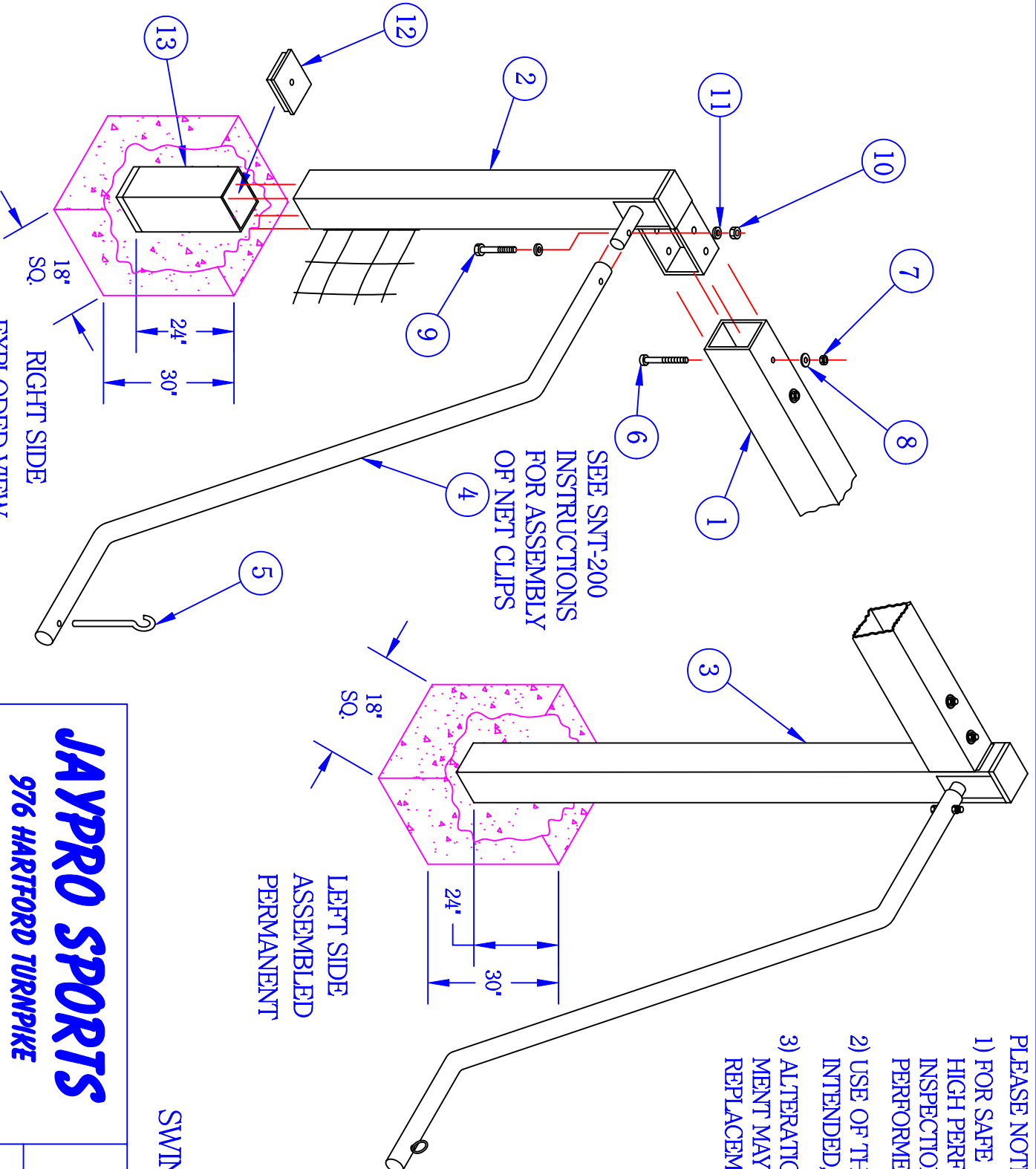

SEE SNT-200 INSTRUCTIONS FOR ASSEMBLY OF NET CLIPS

LEFT SIDE ASSEMBLED PERMANENT

RIGHT SIDE EXPLODED VIEW SEMI-PERMANENT WITH OPTIONAL SLEEVES

CAUTION
DO NOT HANG OR SWING FROM CROSSBARS

JAYPRO SPORTS

976 HARTFORD TURNPIKE
WATERFORD, CT 06385 USA

(800)243-0533
(800)988-3363 FAX
WWW.JAYPRO.COM

MODEL NO.: SGP-730

PRODUCT NAME:
OFFICIAL ALUMINUM PERM.
SEMI-PERM. SOCCER GOALS

DRAWN BY: JAC **EFFECTIVE DATE:** 5-29-03

JAYPRO SPORTS
 PERM. AND SEMI-PERM. SOCCER GOALS, SGP-730
LIST OF MATERIALS

<u>PIECE NO.</u>	<u>PART NO.</u>	<u>DESCRIPTION</u>	<u>QTY.</u>
1	SGP760XBS	Crossbar	2
2	SGP730UPR	Upright-Right Side	2
3	SGP730UPL	Upright-Left Side	2
4	SGP730BS	Backstay	4
5	SR1467	Ground Stake	4
6	HB5010	Carriage Bolt 3/8"-16 x 4 1/2"	8
7	HN265	Locknut 3/8"-16	8
8	HW2050	Flatwasher 3/8"	8
9	HS5015	Hex Head Screw 5/16"-18 x 2 1/4"	4
10	HN261	Locknut 5/16"-18	4
11	HW2049	Washer 5/16"	8
12	AF822A	Sleeve-Top Cap (SGP-735G Only)	4
13	SGP735G1A	Ground Sleeve (SGP-735G Only)	4

ASSEMBLY INSTRUCTIONS

READ ALL DIRECTIONS CAREFULLY BEFORE BEGINNING ASSEMBLY.

TOOLS REQUIRED: 9/16" Box Wrench Or Adjustable Wrench
 1/2" Box Wrench Or Adjustable Wrench

- 1) Locate your position for the goal uprights (2 & 3) on the soccer field. The proper center to center upright spacing is 24'-4". Dig the footing holes to the dimensions as shown on the illustration. These are minimum suggested dimensions for average soil conditions.
- 2) To assure a proper alignment of the goal facing within the footing, it is necessary to assemble the uprights (2 & 3) to the crossbar (1) before cementing the structure into place. Slip a left-side upright (3) and a right-side upright (2) into each end of the crossbar (1) as shown in the illustration. Assemble the net clips onto each upright and crossbar per separate snt-200 instructions.
- 3) Assemble the carriage bolts 3/8"-16 x 4 1/2" (6), flatwasher 3/8" (8) and locknut 3/8"-16 (7) as indicated. When the carriage bolts (6) are first assembled, they will not seat fully into the hole in the crossbar (1). However, when tightened, the head will draw into the material and form a square hole to lock firmly in place.
- 4) Semi-permanent installation (sgp-735):
 Slip the ground sleeves (13) onto the bottom of each upright and lower the assembled goal facing into the footings. Block beneath and around the sleeves, plumb the structure and pour the footing. Check that the ground sleeve does not protrude above the playing surface and that the distance from the playing surface to the underside of the crossbar is 8'. Brace the structure to assure that it does not shift during the footing curing process.

Permanent installation process (sgp-730):

Lower the assembled goal facing into the footings. Block beneath and around each upright, plumb the structure and pour the footing. Check that the distance between the playing surface and the crossbar of the upright is 8'. Brace the structure to assure that it does not shift during the footing curing process.

- 5) Wait for the concrete to fully cure according to the manufacturer's instructions. When the process is complete, assemble the backstays (4) as shown and stake the loose end securely to the ground.
- 6) If the unit is removed from the ground sleeves for maintenance or storage, always cover the open end of the sleeve using the top cap (12) provided.

INSTALLATION AND USE CONSIDERATIONS

To protect the players and playing area, the carriage bolts 3/8"-16 x 4 1/2" (6) must assemble up from the bottom side of the crossbar (1) as shown in the illustration. When this bolt is first assembled and tightened, it will create a small square impression underneath the head. This square hole will prevent the bolt from turning during assembly. Always insert the carriage bolt head into the square hole when performing this assembly operation.